

NO	DESCRIPTION	MATERIAL	Q'TY	SIZE	REMARKS
1	MOTOR	T.E.F.C	1 SET	2HPx6P	3#220/380/440V/60Hz
2	FAN	AL+ALLOY	1 SET	#900	4 BLADES
3	SPRINKLER HEAD	P.V.C	1 SET	100A	
4	SPRINKLER PIPE	P.V.C	4 EA	50A	
5	FILLER	P.P	1 LOT	0.4 <sup>t</sup>	ROLL TYPE
6	CASING	F.R.P	1 SET		
7	LOUVER	F.R.P	1 SET		

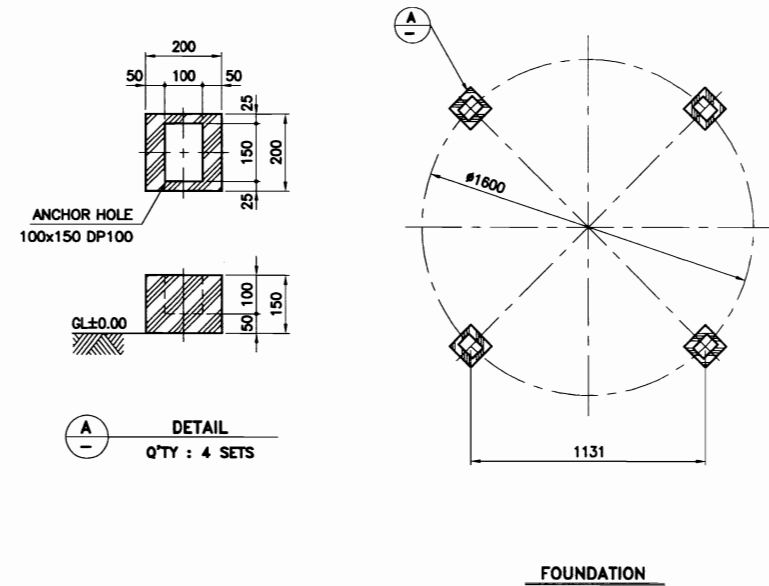

**NOTE**

- REDUCER : DIRECT DRIVE TYPE
- FOUNDATION : R.F CONCRETE (OUT OF SCOPE)
- F.R.P TOLERANCE IS ±20mm.
- NET WEIGHT : 410 KG
- OPERATE WEIGHT : 860 KG

NO.	REVISION	DATE	DRAWN	CHK'D	APP'R	REFERENCE DRAWING
△						
△						
△						
△						

**D H Tech Co., Ltd.**  
 디에이치테크(주)  
 Project NO. \_\_\_\_\_  
 Scale H/S \_\_\_\_\_  
 Unit mm \_\_\_\_\_  
 Date 2003. . . \_\_\_\_\_  
 Size A4 \_\_\_\_\_

**PROJECT :**  
 COOLING WATER SYSTEM  
**TITLE :**  
 ROUND TYPE COOLING TOWER  
 60 R/T ASSY DWG.  
**REF. NO.**  
 RN373227VP00601-001

