

NO	DESCRIPTION	MATERIAL	Q'TY	SIZE	REMARKS
1	MOTOR	T.E.F.C	1 SET	1/4HPx6P	3#220/380/440V/60Hz
2	FAN	AL+ALLOY	1 SET	#500	4 BLADES
3	SPRINKLER HEAD	P.V.C	1 SET	40A	
4	SPRINKLER PIPE	P.V.C	4 EA	15A	
5	FILLER	P.P	1 LOT	0.4 ^t	ROLL TYPE
6	CASING	F.R.P	1 SET		
7	LOUVER	F.R.P	1 SET		

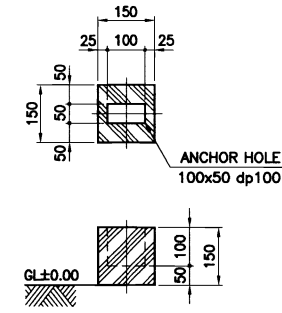

DETAIL
Q'TY : 3 SETS

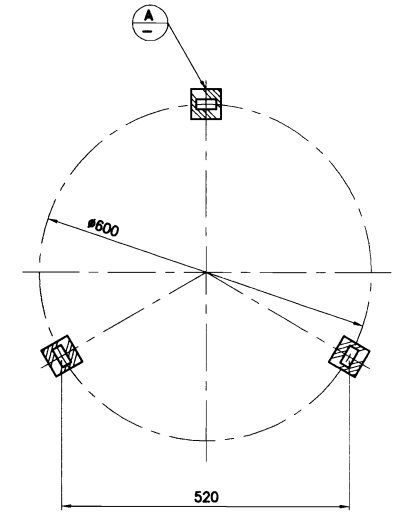

FOUNDATION

NOTE

1. REDUCER : DIRECT DRIVE TYPE
2. FOUNDATION : R.F CONCRETE (OUT OF SCOPE)
3. F.R.P TOLERANCE IS ±20mm.
4. NET WEIGHT : 71 KG
5. OPERATE WEIGHT : 116 KG

NO.	REVISION	DATE	DRAWN	CHK'D	APP'R	REFERENCE DRAWING
△						
△						
△						
△						

<p>D H Tech Co., Ltd. 디에이치테크(주)</p>				PROJECT : COOLING WATER SYSTEM	
				TITLE : ROUND TYPE COOLING TOWER 8 R/T ASSY DWG.	
Project NO. _____ Scale N/S _____ Unit mm _____ Date 2003. . . _____ Size A4 _____				Drawn _____ Design _____ Checked _____ Approved _____	
REF. NO. RN373227FVP00081-001				Rev. No.	