

DAE HWA STANDARD WATER FLOW(LA-TYPE)

NO	DESCRIPTION	MATERIAL	Q'TY	SIZE	REMARKS
1	MOTOR	T.E.F.C	1 SET	20HPx4P	3ø/220/380/440V/60Hz
2	REDUCER	V-BELT	1 SET	600R/T	B - 61" x 11EA
3	MOTOR BASE	SS400+H.D.G	1 SET		
4	FAN	F.R.P	1 SET	ø3400	6 BLADES
5	FAN BOSS	AL+ALLOY	1 SET	ø605	
6	UPPER BODY	F.R.P	16 PI		
7	TURN BUCKLE	SS400+H.D.G	8 EA		
8	SPRINKLER HEAD	AL+ALLOY	1 SET	250A	
9	SPRINKLER PIPE	P.V.C	1 SET	75A	
10	ELIMINATOR	F.R.P	1 SET	2 ^t	
11	CENTER BODY	F.R.P	16 PI		
12	FILLER	P.P	1 LOT	0.4 ^t	SQUARE TYPE
13	CENTER PIPE	S.G.P+H.D.G	1 SET	250A	
14	FILLER SUPPORT	SS400+H.D.G	1 SET		
15	SUPPORT	S.G.P+H.D.G	1 SET	32A	
16	LADDER	S.G.P+H.D.G	1 SET	20A	
17	UNDER BODY	F.R.P	16 PI		
18	STRAINER	SS400+H.D.G	1 SET		
19	SUCTION TANK	SS400+H.D.G	1 SET	ø483	
20	LEG	SS400+H.D.G	1 SET	40A	

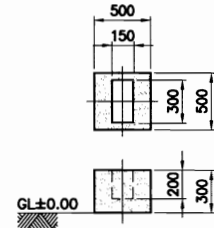

DETAIL "B"

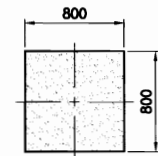

DETAIL "A"

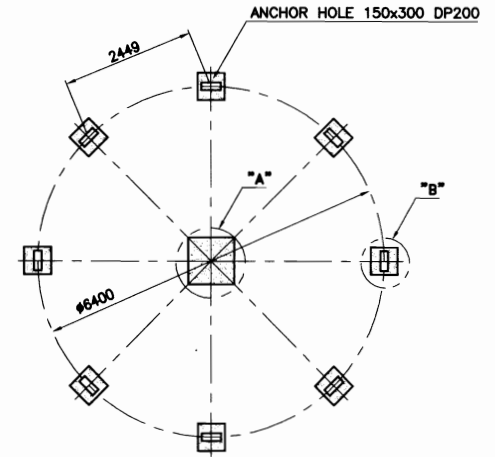

BASE FOUNDATION

NOTE

- FOUNDATION : R.F CONCRETE (OUT OF SCOPE)
- F.R.P TOLERANCE IS ±20mm.
- NET WEIGHT : 4174 KG
- OPERATE WEIGHT : 9321 KG

NO.	REVISION	DATE	DRAWN	CHK'D	APP'R	REFERENCE DRAWING
△						
△						
△						
△						

				PROJECT : COOLING WATER SYSTEM	
Project NO.				TITLE : ROUND TYPE COOLING TOWER 600 R/T ASSY DWG.	
Scale	N/S	Drawn			
Unit	mm	Design			
Date	2003.	Checked			
Size	A4	Approved		REF. NO. RN373227FVP06001-001	Rev. No.