

NO	DESCRIPTION	MATERIAL	Q'TY	SIZE	REMARKS
1	MOTOR	T.E.F.C	1 SET	3HPx8P	3#220/380/440V/60Hz
2	MOTOR BASE	SS400+H.D.G	1 SET		
3	FAN	AL+ALLOY	1 SET	#1200	6 BLADES
4	UPPER BODY	F.R.P	4 PI		
5	TURN BUCKLE	SS400+H.D.G	4 EA		
6	SPRINKLER HEAD	AL+ALLOY	1 SET	125A	
7	SPRINKLER PIPE	P.V.C	1 SET	65A	
8	ELJMINATOR	F.R.P	1 SET	2 ^t	
9	CENTER BODY	F.R.P	4 PI		
10	FILLER	P.P	1 LOT	0.4 ^t	SQUARE TYPE
11	CENTER PIPE	S.G.P+H.D.G	1 SET	125A	
12	FILLER SUPPORT	SS400+H.D.G	1 SET		
13	SUPPORT	S.G.P+H.D.G	1 SET	20A	
14	LADDER	S.G.P+H.D.G	1 SET	20A	
15	UNDER BODY	F.R.P	4 PI		
16	STRAINER	SS400+H.D.G	1 SET		
17	SUCTION TANK	SS400+H.D.G	1 SET	250A	
18	LEG	SS400+H.D.G	1 SET	25A	

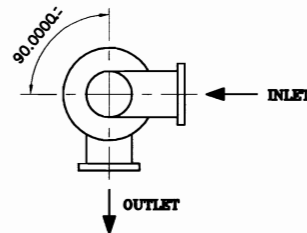
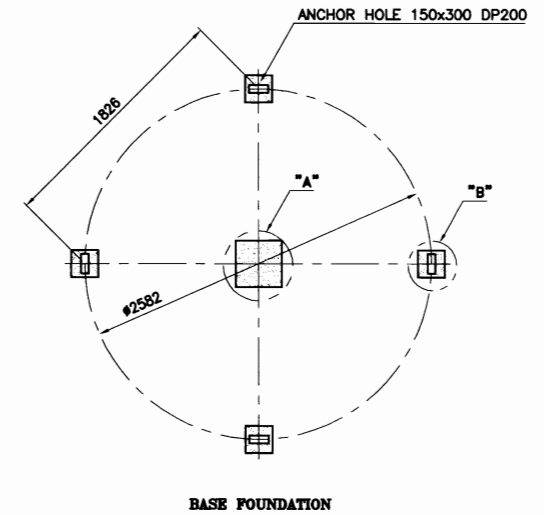
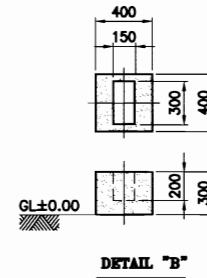

DAE HWA STANDARD WATER FLOW(LA-TYPE)

NOTE

1. REDUCER : DIRECT DRIVE TYPE
2. FOUNDATION : R.F CONCRETE (OUT OF SCOPE)
3. F.R.P TOLERANCE IS ±20mm.
4. NET WEIGHT : 675 KG
5. OPERATE WEIGHT : 1362 KG

NO.	REVISION	DATE	DRAWN	CHK'D	APP'R	REFERENCE DRAWING
△						
△						
△						
△						

D H Tech Co., Ltd.
 (주) 디에이테크
 Project NO. _____
 Scale: N/S
 Unit: mm
 Date: 2003. . . .
 Size: A4

Drawn: _____
 Design: _____
 Checked: _____
 Approved: _____

PROJECT :
 COOLING WATER SYSTEM

TITLE :
 ROUND TYPE COOLING TOWER
 100 RT ASS'Y DWG.

REF. NO.
 RN373227F/VP01001-001

Rev. No.